

IN THE DISTRICT COURT / I TE KŌTI Ā ROHE
ROTORUA / TE ROTORUA-NUI-A-KAHUMATAMOMOE

CIV-2024-063-000364

UNDER THE LOCAL GOVERNMENT ACT 2002

IN THE MATTER of an application for an injunction to restrain commission
of an offence under s 162

BETWEEN ROTORUA DISTRICT COUNCIL

Applicant

AND ROTOKĀKAHI BOARD OF CONTROL

First Respondent

AND PERSON/S UNKNOWN

Second Respondent/s

AFFIDAVIT OF CHRISTINE MARGARET GAVIN IN SUPPORT OF AN APPLICATION
FOR AN INJUNCTION
Affirmed: 8 October 2024

TOMPKINS | WAKE

Kate Cornegé (kate.cornege@tompkinswake.co.nz)
Connor Gordon (connor.gordon@tompkinswake.co.nz)

Westpac House
Level 8
430 Victoria Street
PO Box 258
DX GP 20031
Hamilton 3240
New Zealand
Ph: (07) 839 4771
tompkinswake.com

233086
3474-8511-2369-V1

AFFIDAVIT OF CHRISTINE MARGARET GAVIN IN SUPPORT OF AN APPLICATION FOR AN INJUNCTION

I, **Christine Margaret Gavin**, of Hamilton, Associate, solemnly and sincerely affirm:

1. I am an Associate at the firm Tompkins Wake, which acts for the applicant in this proceeding, Rotorua District Council (the **Council**). I am authorised to provide this affidavit for the Council.
2. I have access to, and am familiar with, the contents of the file in this matter.
3. I am providing this affidavit in support of the Council’s application for an injunction restraining the commission of offences (renewed and amended) dated 1 October 2024.
4. Annexed to this affidavit and marked “**A**” is a plan (**Plan**) identifying the road fronting the land described as “**C**” in the image at paragraph 25 of the affidavit of Wally Lee sworn 7 October 2024 filed on behalf of the first respondent, Rotokākahi Board of Control.
5. The Plan is sourced from the Land Information New Zealand database, Landonline.
6. The area shaded red in the Plan to the north of the road is part of the title described as area “**B**” in the image at paragraph 25 of the affidavit of Wally Lee sworn 7 October 2024, which is a scenic reserve owned by His Majesty the King.

Signature of Deponent: 
.....
Christine Margaret Gavin

Affirmed by the abovenamed **Christine Margaret Gavin** at Hamilton this 8th day of October 2024 before me:

.....
Quinn McKay
Solicitor
Hamilton
A Solicitor of the High Court of New Zealand

"A"

EXHIBIT NOTE

This is the annexure marked "A" referred to in the affidavit of **Christine Margaret Gavin** affirmed at Hamilton this 8th day of October 2024 before me:

Quinn McKay

Signature.....*Quinn McKay*
A Solicitor of the High Court of New Zealand

Solicitor
Hamilton

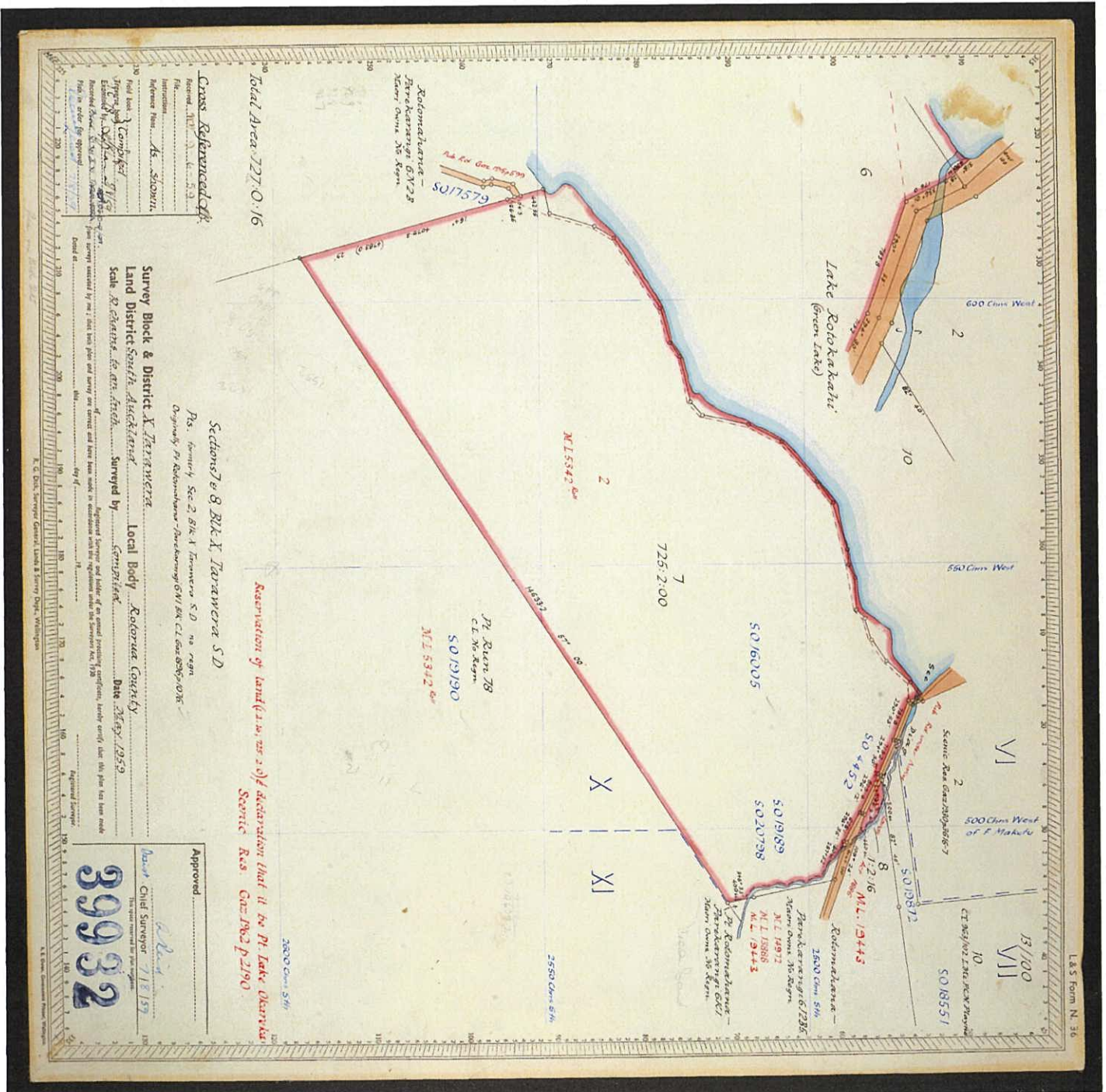

Quinn McKay