



This plan has been prepared in accordance with an agreement for services and should not be used for any other purpose without the written consent of Terrasurv Limited.

**Notes**

- 1) Surveyed: 22/8/24
- 2) Coordinates: NZGD2000 Bay of Plenty Circuit
- 3) Levels: NZVD16
- 4) Origin: EK4G  
726789.07mN  
376580.85mE  
416.86m
- 5) Boundary adopted from survey plans
- 6) Contour interval is 0.5m



**Client**  
Tikanga Aroro Charitable Trust

**Site**  
Puaiti Road  
Waikite Valley

**Title**  
Topographic Survey  
Lot 1 DP 585350

**Date** 28 Aug 2024      **Scale** 1:300@A1  
**Drawing** 24034-T-1

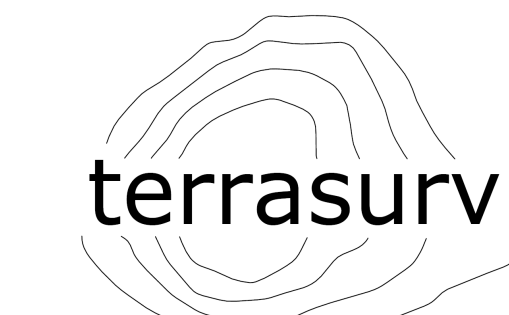

www.terrasurv.nz | 07 393 3377



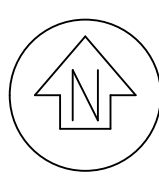

This plan has been prepared in accordance with an agreement for services and should not be used for any other purpose without the written consent of Terrasurv Limited.

- Notes**
- 1) Surveyed: 22/8/24
  - 2) Coordinates: NZGD2000 Bay of Plenty Circuit
  - 3) Levels: NZVD16
  - 4) Origin: EK4G  
726789.07mN  
376580.85mE  
416.86m
  - 5) Boundary adopted from survey plans
  - 6) Contour interval is 0.5m

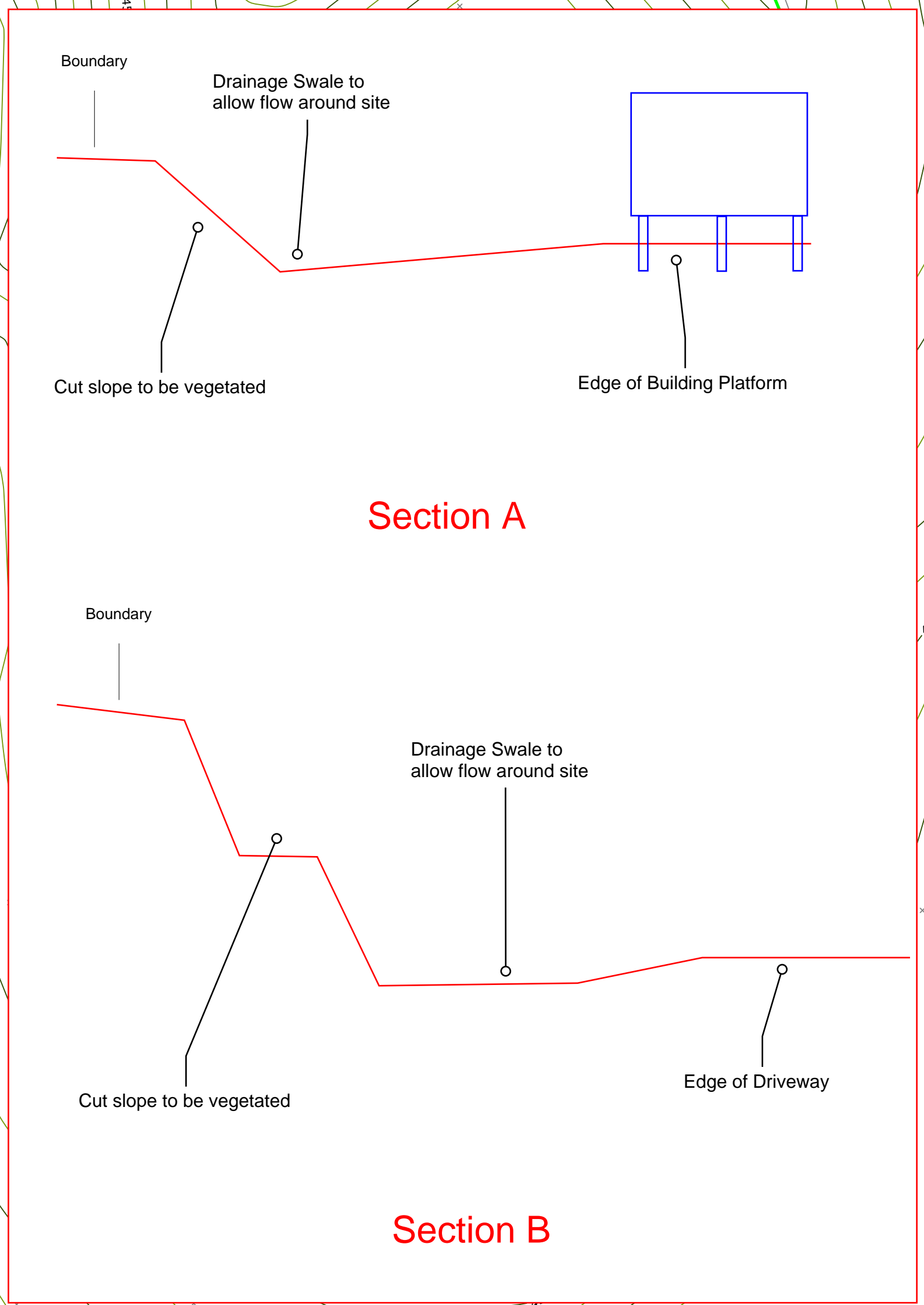
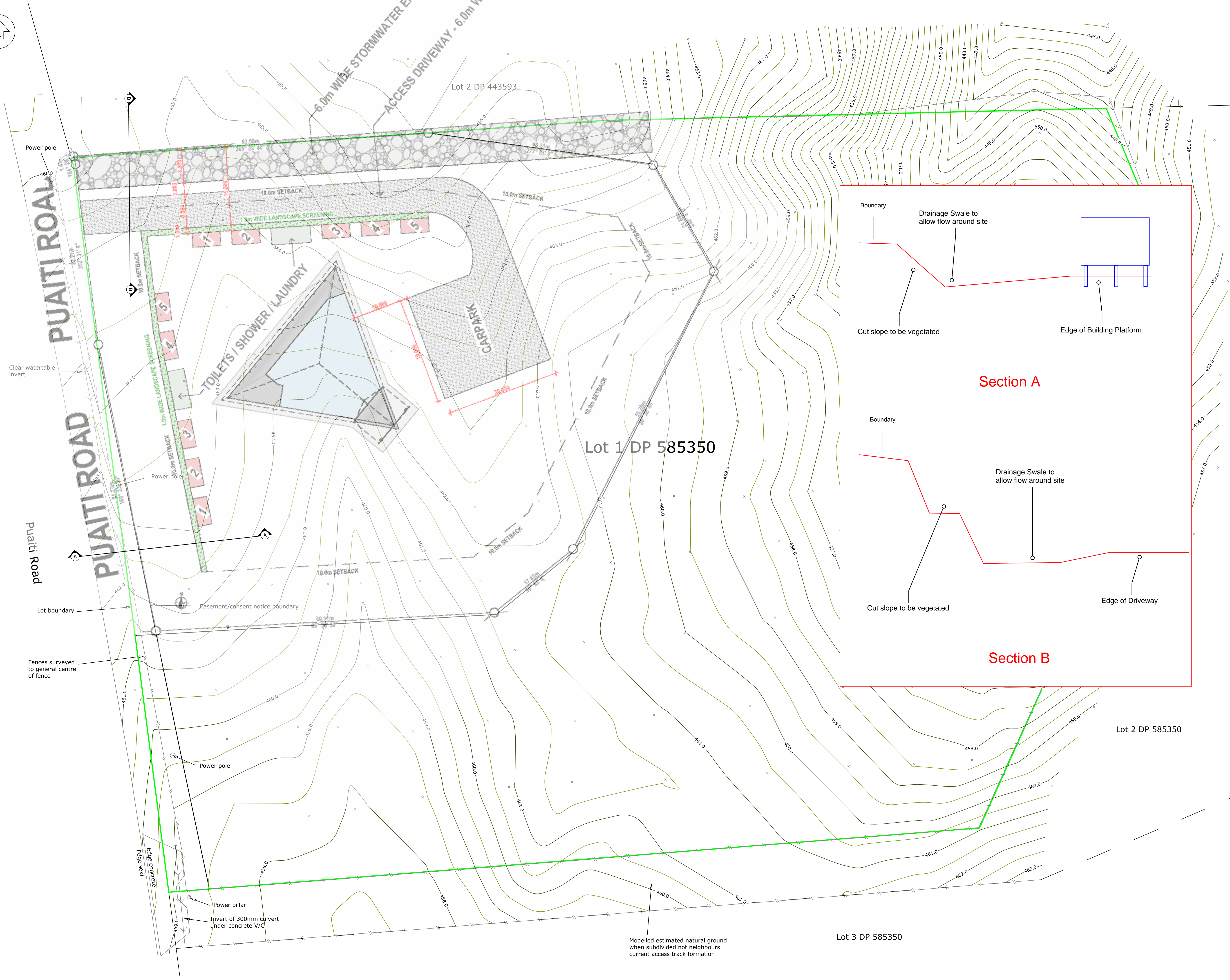

**Client**  
Tikanga Aroro Charitable Trust

**Site**  
Puaiti Road  
Waikite Valley

**Title**  
Topographic Survey  
Lot 1 DP 585350

**Date**  
28 Aug 2024

**Scale**  
1:300@A1

**Drawing**  
24034-T-1



www.terrasurv.nz | 07 393 3377